

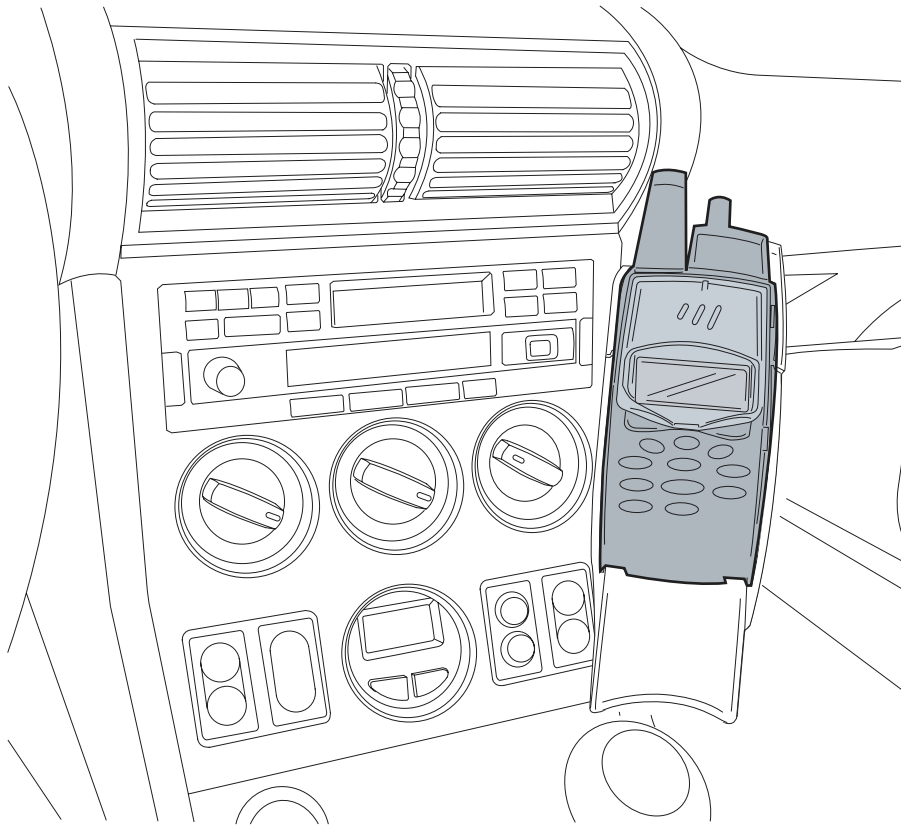

Parts and Accessories Installation Instructions



036 0086 Z

Retrofit hands-free kit for Ericsson mobile phones Series T39 BMW Z3 (E36/7) roadster and coupé

The installation time is approx. 2 hours, but this may vary depending on the condition of the car and the equipment in it.

Retrofit kit No. 84 64 0 147 581

Contents

| Section | Page |
|--|------|
| Important information..... | 3 |
| 1. Preparations..... | 4 |
| 2. Parts list | 5 |
| 3. Hands-free kit connection overview | 6 |
| 4. Installation and cabling diagram..... | 7 |
| 5. To install and connect the wiring harness | 8 |
| 6. To install the speaker | 9 |
| 7. To install the hands-free microphone and adhesive windscreen aerial | 10 |
| 8. To install the telephone console and hands-free control module | 11 |
| 9. Concluding work | 14 |
| 10. Hands-free kit circuit diagram | 15 |

Important information

Only for use in the BMW dealer organisation.

Subject to technical modifications.

If the specified PIN chambers are occupied, bridges, double crimps or twin-lead terminals must be used.

This system does not require coding

Installation information

Before starting the installation work clean the screen with conventional cleaning products.

Do not touch the adhesive strips and cleaned screen.

Never attempt to affix the adhesive screen aerial to a misted or damp screen.

The gluing temperature of the screen must be at least 20°C.

The adhesive strip and adhesive screen aerial will bond immediately on contact and cannot be moved again.

To ensure a permanent bond allow the car to stand in an ambient temperature of at least 20°C for approx. two hours.

Ensure that the cables/lines are not kinked or damaged as you install them in the car.

Target group

The target group for these installation instructions is specialist personnel trained on BMW cars with the appropriate specialist knowledge.

All work must be completed using the latest BMW repair manuals, circuit diagrams, servicing manuals and work instructions in a rational order using the prescribed tools (special tools) and observing current health and safety regulations.

Required special tools

DIS or MoDiC

1. Preparations

| | TIS instruction No. |
|---|----------------------------|
| Conduct a brief test | --- |
| Disconnect the negative pole of the battery | 12 00 ... |
| The following components must be removed first of all: | |
| Glove box on the right | 51 16 360 |
| Sun visors, left and right | 51 16 104 |
| Interior rear-view mirror | 51 60 063 |
| Trim for the roof pillar, front left and right | 51 43 201 |
| Trim for the front headlining (windscreen panel, top) | 51 44 150 |
| Radio | 65 51 030 |

2. Parts list

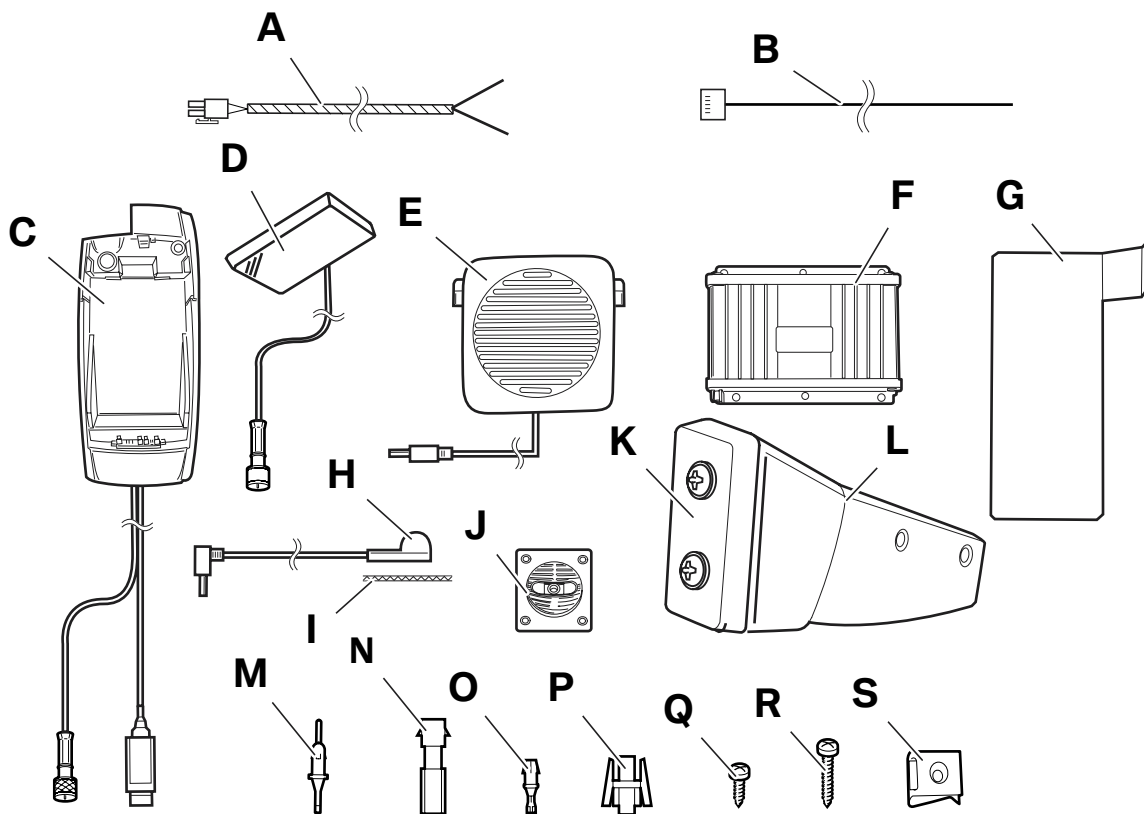

Legend

- A Power supply wiring harness
- B Mute circuit wiring harness
- C Mobile phone holder
- D Adhesive windscreen aerial
- E Speaker
- F Hands-free control module
- G Hands-free control module holder
- H Hands-free microphone
- I Velcro tape
- J Retaining plate for the mobile phone holder
- K Telephone console, top section
- L Telephone console, bottom section
- M Plug contact (3x)
- N Plug casing (3x)
- O Socket contact (4x)
- P Socket casing (3x)
- Q Self-tapping screw 4 x 16 (4x)
- R Self-tapping screw 4 x 46 (2x)
- S Speed nut (2x)

036 0087 Z

3. Hands-free kit connection overview

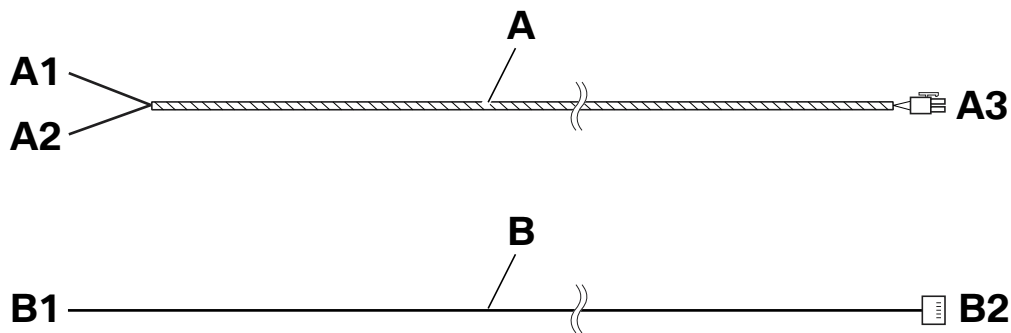

036 0088 Z

| Item | Description | Signal | Cable colour / Cross-section | Connection location in the car | Abbreviation / Slot |
|------|-----------------------------|----------------|------------------------------|---|---------------------|
| A | Power supply wiring harness | --- | --- | --- | --- |
| A1 | Cable branch | Earth | BR 0.75 mm ² | With enclosed socket and plug contact on radio plug | X18126 PIN 15 |
| A2 | Cable branch | Terminal 30 | RT 0.75 mm ² | With enclosed socket and plug contact on radio plug | X18126 PIN 9 |
| A3 | 2-pin SW plug | --- | --- | To hands-free control module | --- |
| B | Mute circuit wiring harness | --- | --- | --- | --- |
| B1 | Cable branch | Mute | SW 0.5 mm ² | With enclosed socket and plug contact to the radio plug | X18126 PIN 4 |
| B2 | WS 5-pin plug | --- | --- | To hands-free control module | --- |

4. Installation and cabling diagram

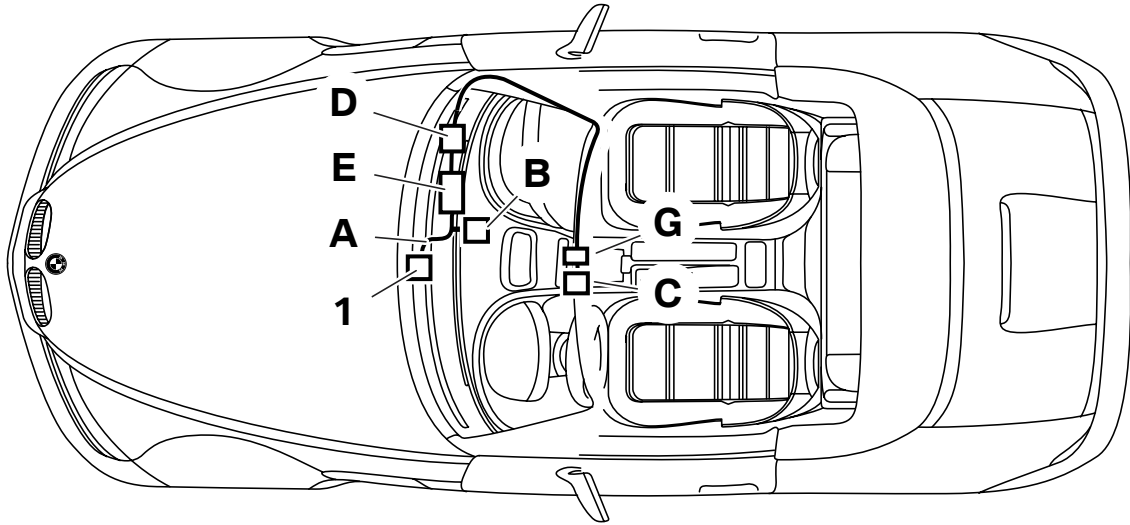

036 0112 Z

Legend

- 1 Radio plug X18126
- A Hands-free kit control module wiring harness
- C Mobile phone holder
- D Adhesive windscreen aerial
- E Speaker
- F Hands-free control module
- H Hands-free microphone

5. To install and connect the wiring harness

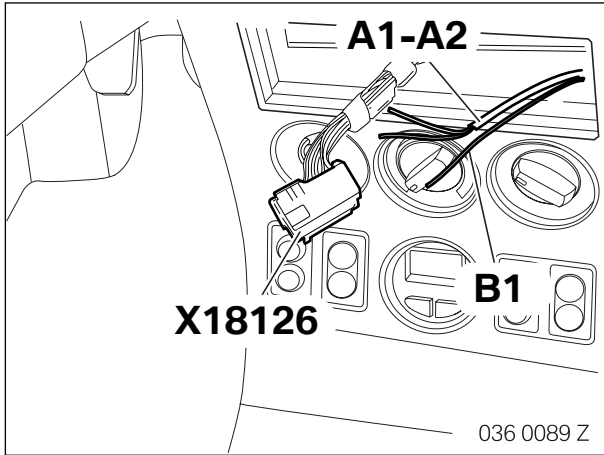

Lay branches **A1 – A2** and **B1** to the radio plug **X18126**.

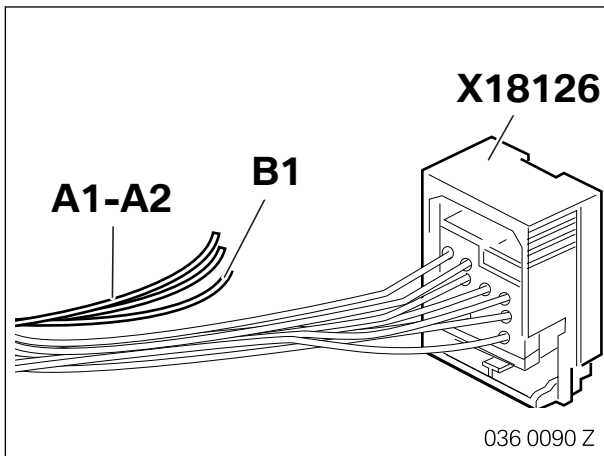

Connect branches **A1 – A2** as follows to the cables in plug **X18126**:

- **A1**, SW cable, to BR cable PIN 15
- **A2**, RT cable, to RT/GN cable PIN 9
- **B1**, SW cable, to WS/SW cable PIN 4

See figure 036 0092 Z for the procedure

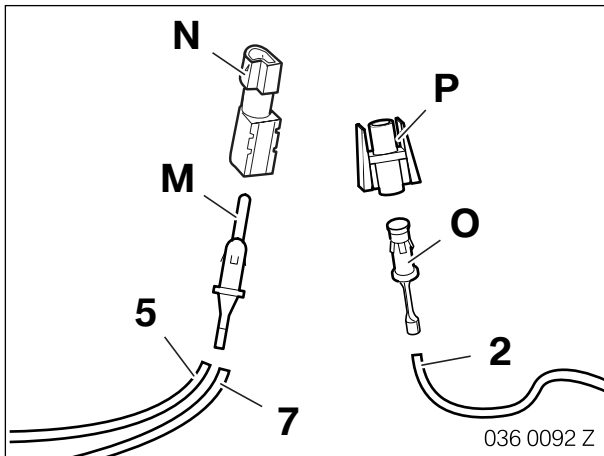

Cut the corresponding cable of the plug **X18126** at a suitable point.

Crimp the socket contact **O** on to the cable end (2) of the plug and connect the socket casing **P**.

Crimp the plug contact **M** on to the open cable end (5), crimp on the corresponding branch (7) and connect the plug casing **N**.

Connect the socket and plug casings.

6. To install the speaker

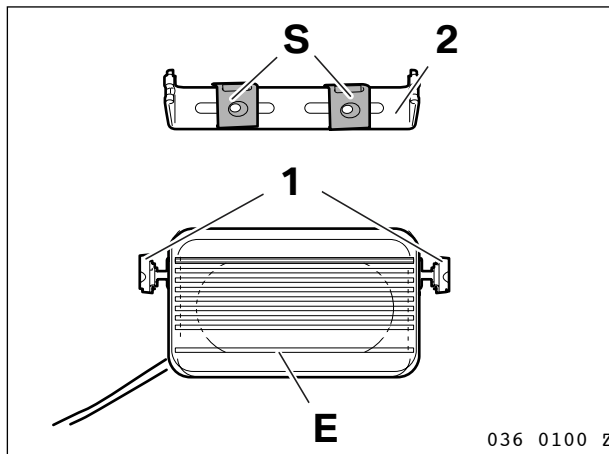

Unscrew both knurled-head bolts (1) and remove the holder (2) from the speaker **E**.

Place speed nuts **S** on the holder (2).

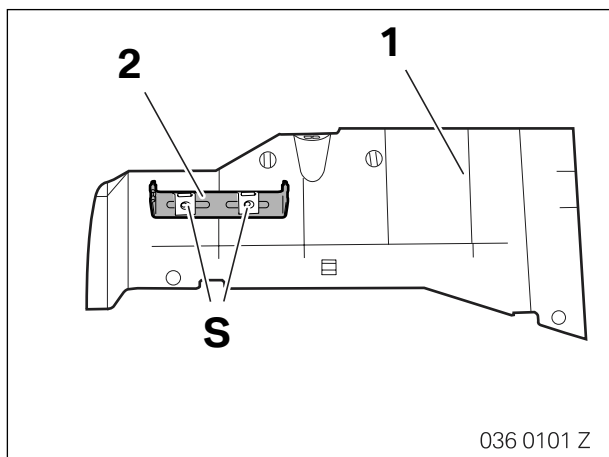

Position the holder (2) on to the bottom trim (1) as shown and mark it.

Drill the fastening holes with a 3.0 mm twist drill.

Secure the holder (2) with Philips screws and speed nuts **S**.

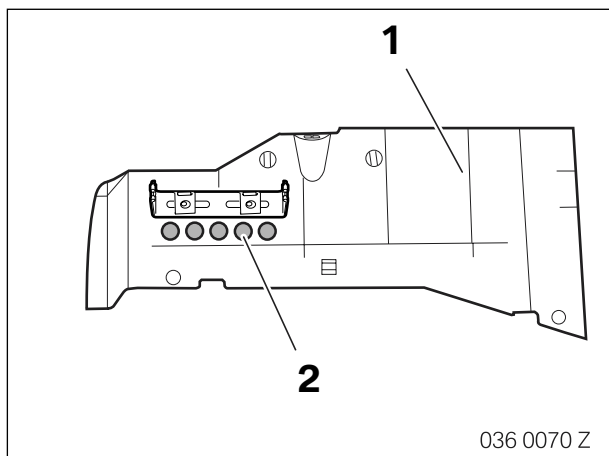

Drill the sound outlet holes (2) as shown in the bottom trim (1) with a 16 mm peel drill.

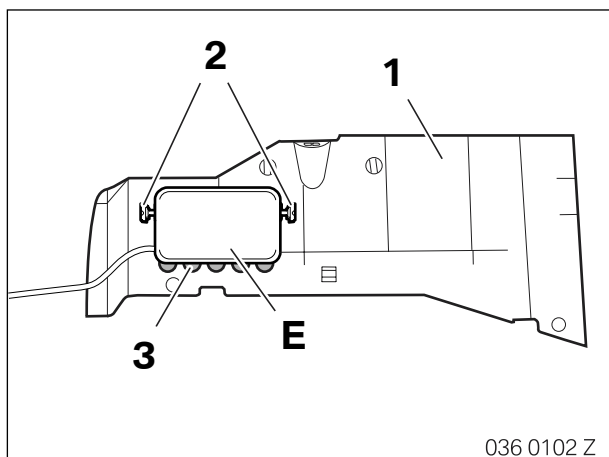

 Insert the speaker **E** into the bottom trim (1) so that the speaker opening points towards the noise outlet opening (3). ◀

Insert the speaker **E** into the holder and secure it with the knurled-head bolts (2).

7. To install the hands-free microphone and adhesive windscreen aerial

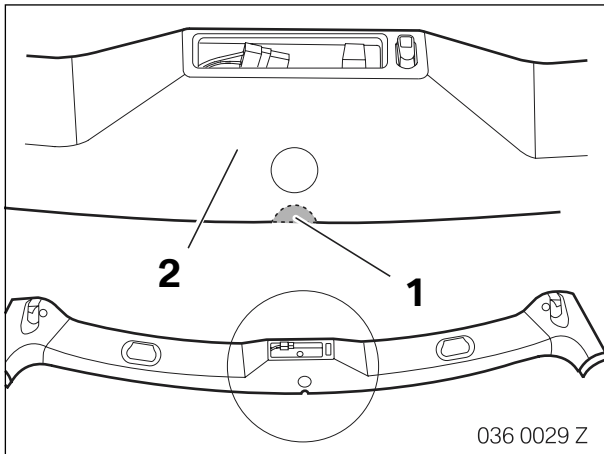

File out the cable passage hole (1) near the interior light with a round file in the windscreen panel trim (2).

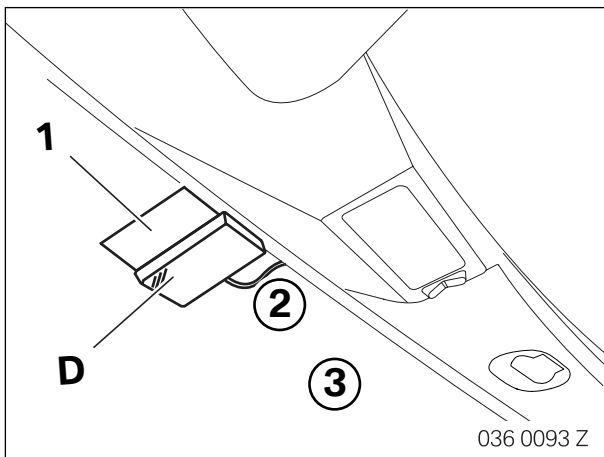

Clean the windscreen in the area where the aerial is to be affixed, see "Important information".

Remove the transparent backing foil from the adhesive strip (1).

Affix the adhesive strip (1) to the left of the interior rear-view mirror (2) from the inside on the windscreen (3).

Press out any air bubbles.

Remove the yellow backing foil from the adhesive strip (1).

Place the adhesive windscreen aerial **D** on to the adhesive strip and press it into position for approx. 15 seconds.

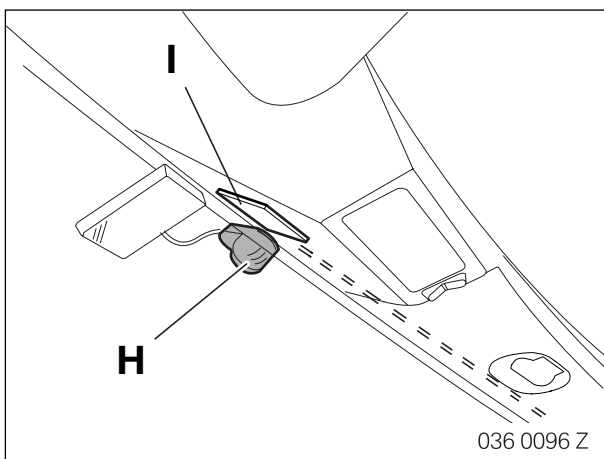

Affix the hands-free microphone **H** to the windscreen panel trim as shown using a Velcro fastener **I**.

Lay the aerial cable and microphone cable through the opening you have filed out to the passenger side.



Do not damage the adhesive windscreen aerial and the hands-free microphone as you install the sun visors. ◀

8. To install the telephone console and hands-free control module

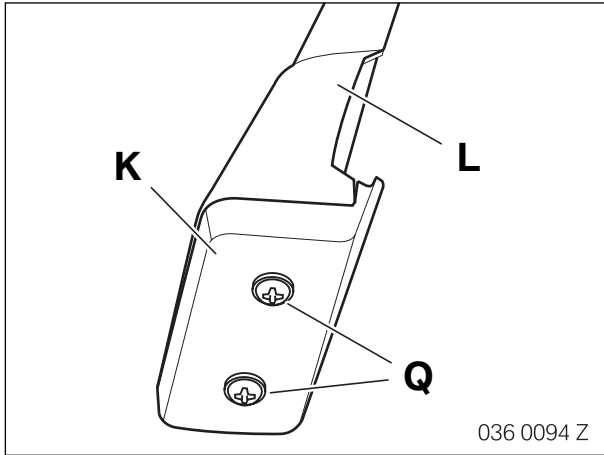

Connect the bottom section of the telephone console **L** to the top section **K**.

Drill holes with a 3 mm twist drill and connect the bottom section **L** and the top section **K** using Philips screws **Q**.

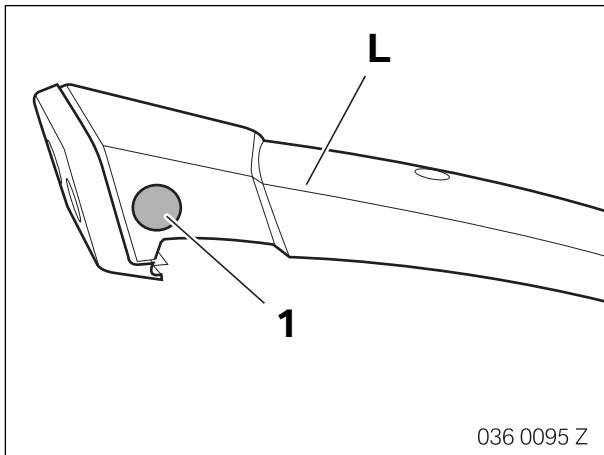

Drill the cable passage (1) for the mobile phone holder in the bottom section of the telephone console **L** as shown using a 22 mm peel drill.

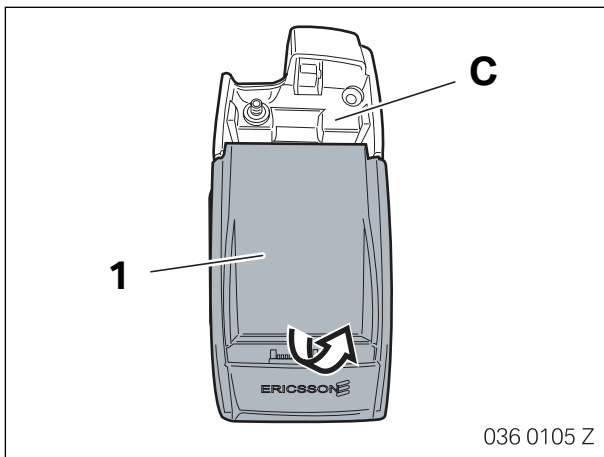

Remove the bottom section (1) from the mobile phone holder **C**.

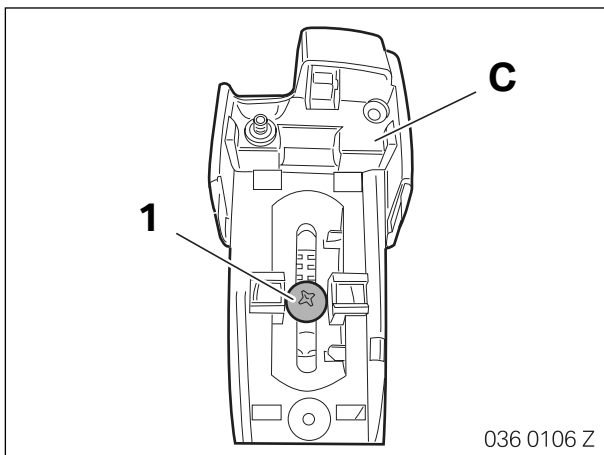

Remove the Philips screw (1) and take the mobile phone holder **C** off the retaining plate.

8. To install the telephone console and hands-free control module

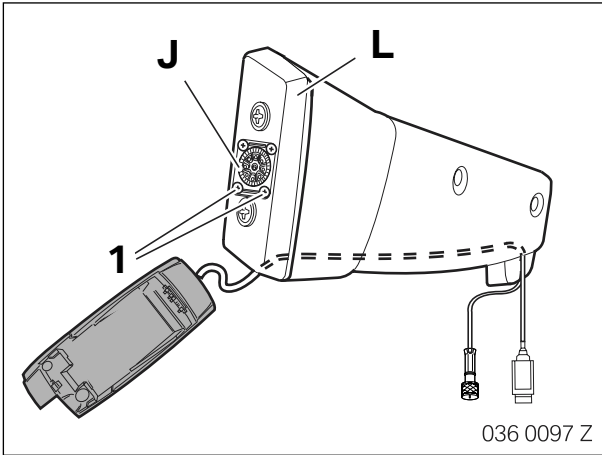

Place the retaining plate **J** on the top section of the telephone console **L** and mark the fixing holes.

Drill the holes with a 3 mm twist drill and secure the retaining plate **J** with Philips screws (1).

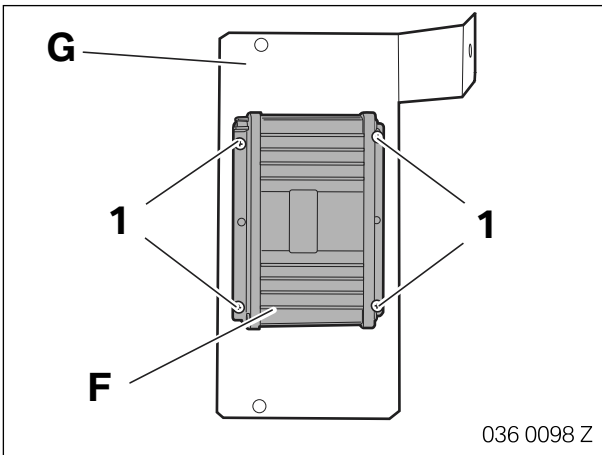

Place the hands-free control module **F** on the holder **G** and mark the fixing holes.

Drill the holes with a 3 mm twist drill and secure the hands-free control module **F** with Philips screws (1).

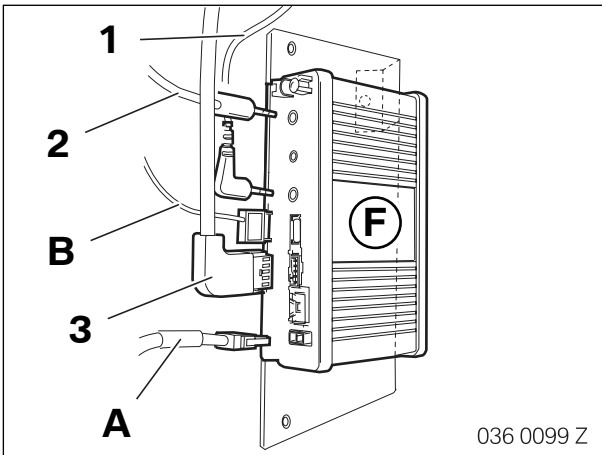

Connect the microphone cable plug (1), the speaker cable plug (2), the mobile phone holder plug (3) and branches **A** and **B** to the hands-free control module **F**.

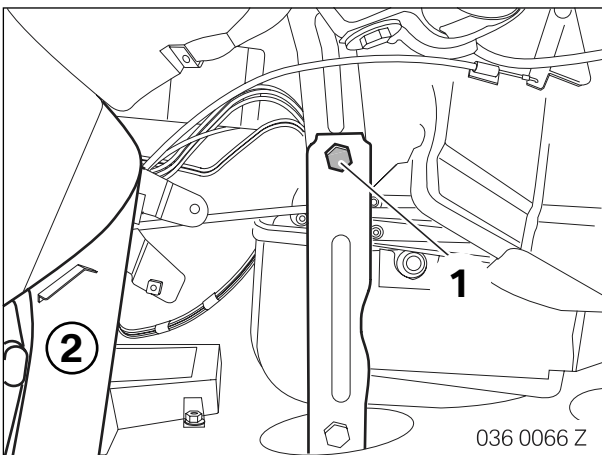

Carefully push the trim (2) for the oddments box in the passenger footwell to the side.

Remove the top retaining screw (1) from the mounting support.

8. To install the telephone console and hands-free control module

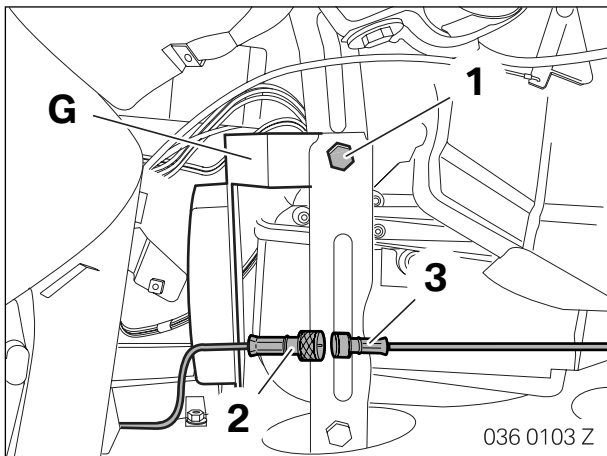

Secure the hands-free control module and holder **G** to the retaining screw (1).

Connect the aerial cable from the mobile phone holder (2) and adhesive windscreen aerial (3).

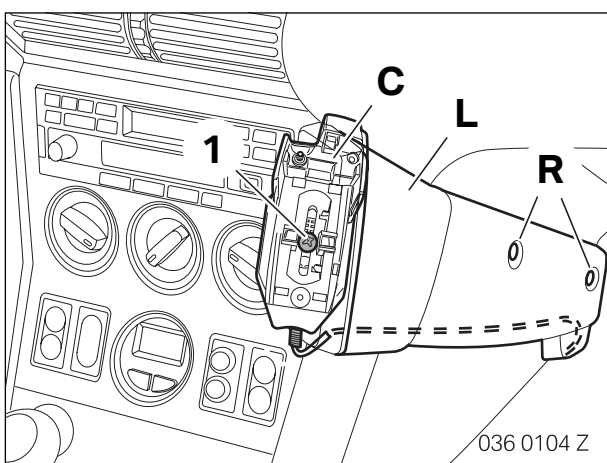

Do not damage the cable as you secure the telephone console. ◀

Secure the mobile phone holder **C** to the retaining plate using the Philips screw (1).

Secure the telephone console **L** using Philips screws **R**.

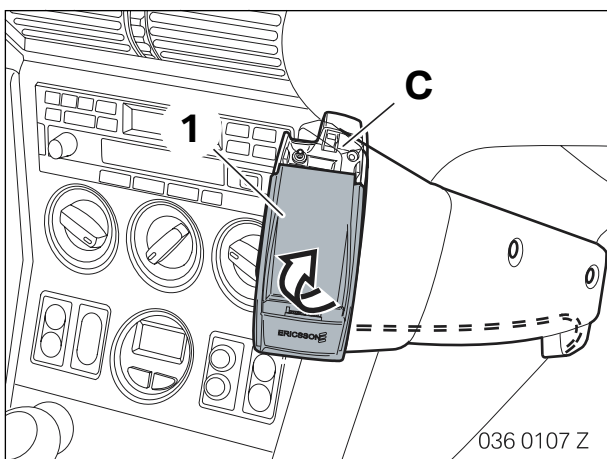

Position the bottom section (1) on the mobile phone holder **C**.

9. Concluding work

- Connect battery
- Conduct a brief test
- Conduct a function test
- Re-assemble the car

10. Hands-free kit circuit diagram

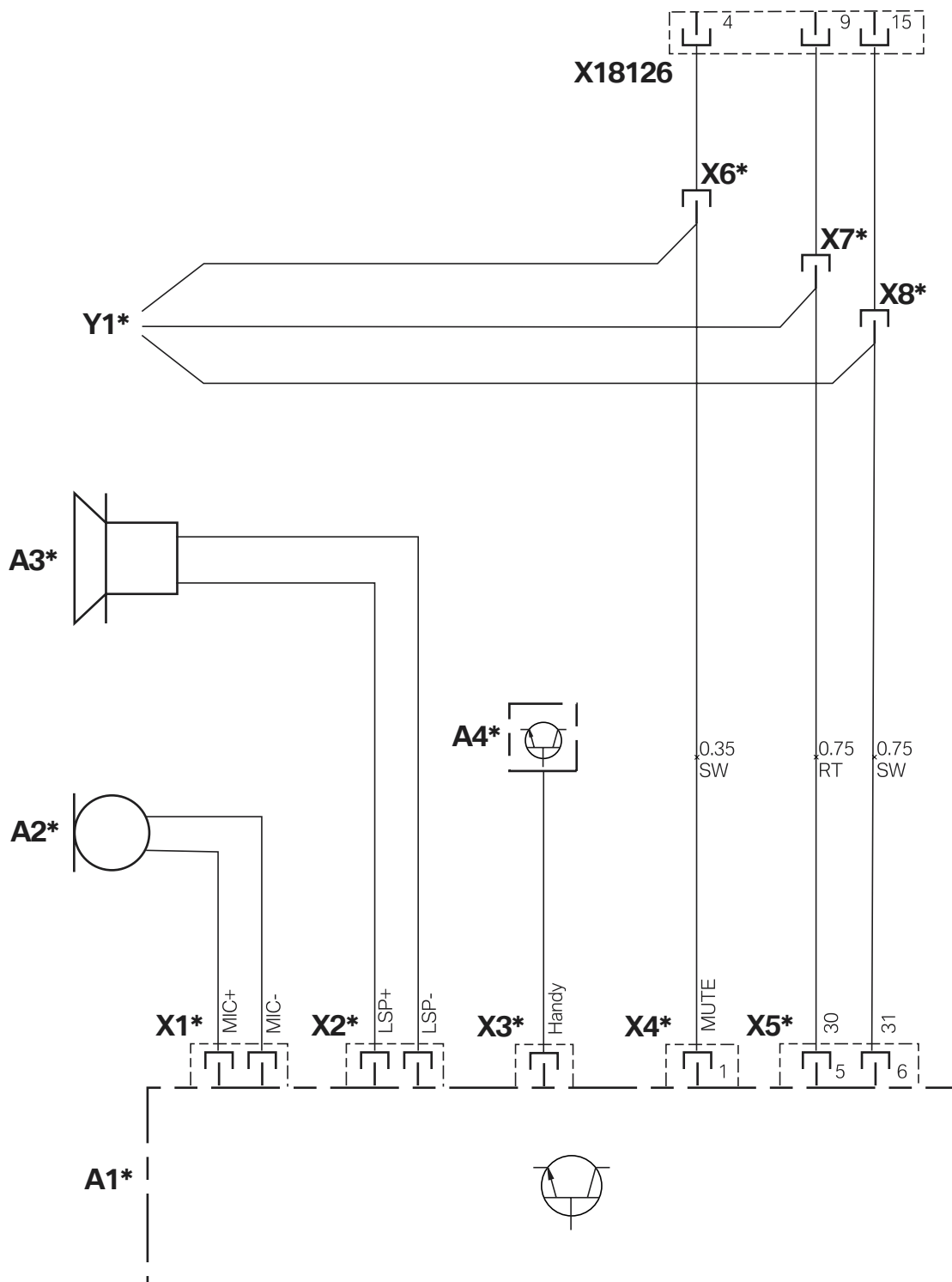

036 0108 Z

10. Hands-free kit circuit diagram

Legend

| | |
|--------|----------------------------|
| A1* | Hands-free control module |
| A2* | Hands-free microphone |
| A3* | Speaker |
| A4* | Mobile phone holder |
| | |
| X1* | SW 2-pin pawl plug |
| X2* | SW 2-pin pawl plug |
| X3* | SW 10-pin plug |
| X4* | WS 5-pin plug |
| X5* | SW 2-pin plug |
| X6* | Twin-lead terminal |
| X7* | Twin-lead terminal |
| X8* | Twin-lead terminal |
| X18126 | Radio plug |
| | |
| Y1* | To standard wiring harness |

All designations with an asterisk (*) only apply to these installation instructions and these circuit diagrams.

Cable colours

| | |
|----|-------|
| RT | red |
| SW | black |
| WS | white |